

# P A T H



Zoccolino luminoso da interno a luce indiretta uniforme per illuminazione di pavimenti o soffitti

- **Applicazioni:** pareti, mobili, soffitti o superfici verticali
- **Ambientazioni:** hotel, musei, centri commerciali, abitazioni private, showroom
- **Installazioni:** da superficie o ad incasso
- **Materiali:** alluminio - policarbonato
- **Finiture:** alluminio anodizzato o bianco opaco rovere rosso o chiaro (previo richiesta)
- **Sorgente LED:** media potenza
- **Ottiche:** diffondenti
- **Efficienza LED:** 140 - 180 lm/W
- **Funzionamento:** accensione on-off o dimmerabile
- **Caratteristiche:** lunghezza fino a 2,5 metri

*Indoor skirting board with uniform indirect light for floors or ceiling lighting*

- **Applications:** walls, furniture, ceilings or vertical surfaces
- **Settings:** hotels, museums, private houses, showroom
- **Installations:** surface mounted or recessed
- **Materials:** aluminium - polycarbonate
- **Finishes:** anodized aluminium or matt white red or light oak (upon request)
- **LED light source:** medium power
- **Optics:** diffused
- **LED efficiency:** 140 - 180 lm/W
- **Functions:** on-off, dimmable
- **Features:** lengths up to 2,5 metres (98,425")

#### Colori LED / LED Colours

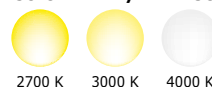

2700 K 3000 K 4000 K

#### Caratteristiche / Features

IP44 IK06 750°C







Versione da superficie  
Surface mounted version







Versione da incasso  
Recessed version

## PATH STRUTTURA / STRUCTURE \*

(Confezione da 6 pezzi / 6 pieces packaging)

example **PAT.02.X00A1.0**

lunghezza length [mm + in]	codice code	+	finiture finishes	+	revisione release
<b>DA SUPERFICIE / SURFACE MOUNTED</b>					
2500 (98,425")	<b>PAT.02.X00</b>		<b>A1</b>  alluminio anodizzato anodized aluminium		<b>.0</b>
<b>DA INCASSO / RECESSED</b>					
2500 (98,425")	<b>PAT.04.X00</b>		<b>W1</b>  bianco opaco matt white		
			<b>C1</b>  rovere rosso red oak		
			<b>C2</b>  rovere chiaro light oak		

\* Abbinare alla struttura un Kit Luce, ACC.0180.0, ACC.0181.0 o ACC.0182.0  
Match one of the Light Kit to the structure, ACC.0180.0, ACC.0181.0 or ACC.0182.0

## PATH KIT LUCE / LIGHT KIT

Kit comprendente: Strip LED - IP20 - certificata ETL + 2 connettori in linea (ACC.0160.0) + 1 connettore a T (ACC.0161.0)  
Kit including: Strip LED - IP20 - ETL certified + 2 through connectors (ACC.0160.0) + 1 T-fitting connectors (ACC.0161.0)



Strip LED 5 m (16.4 ft) - 50 W - 24 Vdc <b>2700 K</b>	Cod. ACC.0180.0
Strip LED 5 m (16.4 ft) - 50 W - 24 Vdc <b>3000 K</b>	Cod. ACC.0181.0
Strip LED 5 m (16.4 ft) - 50 W - 24 Vdc <b>4000 K</b>	Cod. ACC.0182.0

### ACC.0186.0

schermo diffusore adesivo 2500 mm in policarbonato opalino  
adhesive diffuser 2500 mm (98,425") in opal polycarbonate



Esempio di cablaggio derivato  
Derived connection example



Esempio di cablaggio diretto  
Direct connection example

## Riferimenti pagina / Page references

Accessori / accessories	pag. 174
Alimentatori / power supply units	pag. 186
Schemi di collegamento / connection diagrams	pag. 200 - C2

## Note / Notes

Le finiture C1 e C2 sono disponibili previa richiesta / The finishes C1 and C2 are available upon request



## SCHEMA TECNICA

<b>Corpo</b>	estruso in lega di alluminio UNI 6060
<b>Schermo</b>	polycarbonato
<b>Tappi terminali</b>	acciaio inox
<b>Installazione</b>	a muro con viti e tasselli
<b>Cavi di alimentazione</b>	da ordinare separatamente: ACC.0159.0
<b>Sorgenti installabili</b>	da ordinare separatamente: ACC.0180.0, ACC.0181.0, ACC.0182.0
<b>Alimentazione</b>	tensione costante 24 Vdc ( $\pm 5\%$ ), collegamento in parallelo *
<b>Potenza assorbita per metro</b>	10 W *
<b>Efficienza luminosa</b>	140 - 180 lm/W *
<b>Montaggio consigliato</b>	da superficie (parete) - a incasso (parete)
<b>Temperatura di funzionamento</b>	0°C ÷ 40°C *
<b>Peso per metro</b>	<b>versione da superficie:</b> 880 g/m - <b>versione a incasso:</b> 920 g/m
<b>Grado di protezione</b>	IP44, IK06
<b>Marchi</b>	CE, UL
<b>Normativa</b>	prodotti in conformità alle vigenti norme EN60598-1; EN60598-2 e sue parti - UL 2018; IEC 60598-1; CSA C22.2 No. 250.0-08 Certificate number: 20191022-E506810 low voltage lighting systems, power units, luminaires and fittings

## TECHNICAL INFORMATION

<b>Body</b>	aluminium extrusion alloy UNI 6060
<b>Screen</b>	polycarbonate
<b>End caps</b>	stainless steel
<b>Installation</b>	with screws and expansion plugs
<b>Power supply cables</b>	to be ordered separately: ACC.0159.0
<b>Available light sources</b>	to be ordered separately: ACC.0180.0, ACC.0181.0, ACC.0182.0
<b>Power supply</b>	24 Vdc constant voltage ( $\pm 5\%$ ), parallel connection
<b>Power consumption per meter</b>	10 W *
<b>Luminous efficiency</b>	140 - 180 lm/W *
<b>Recommended installation</b>	surface mounted (wall) - recessed (wall)
<b>Working temperature</b>	0°C ÷ 40°C *
<b>Weight per meter</b>	<b>surface mounted version:</b> 880 g/m (31.04 oz/m) - <b>recessed version:</b> 920 g/m (32.45 oz/m)
<b>Protection degree</b>	IP44, IK06
<b>Markings</b>	CE, UL
<b>Norms</b>	products comply with norms EN 60598-1; EN 60598-2 and its parts - UI 2018; IEC 60598-1; CSA C22.2 No. 250.0-08 Certificate number: 20191022-E506810 low-voltage lighting systems, power units, luminaires and fittings

\* Dato riferito al prodotto completo di accessori  
Data referred to the product complete with accessories

### Importante / Remarks:

La temperatura del metallo in prossimità del LED non deve superare il valore di 90°C / The metal's temperature near the LED should not exceed 90°C (194°F)



### Colori LED LED Colours

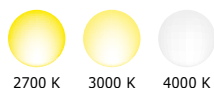

### Finiture Finishes



### Montaggio consigliato Recommended installation

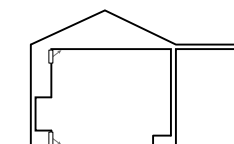

## DISEGNI TECNICI / TECHNICAL DRAWINGS

Dimensioni in mm (in) / Dimensions in mm (in)

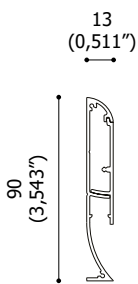
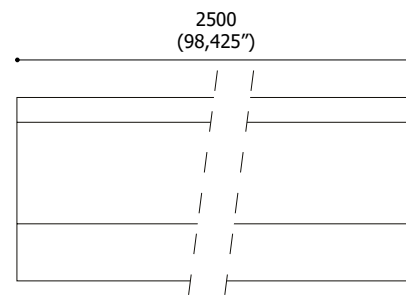
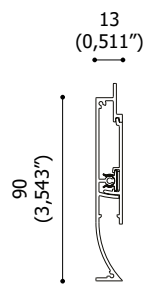
Versione da superficie  
Surface mounted versionVersione da incasso  
Recessed version**Nota:** L'ingresso dei cavi deve essere ad un'altezza da terra compresa tra i 55 mm e i 75 mm.**Note:** The cable entry must be at a height between 55 mm (2,165") and 75 mm (2,952") from the ground.

## ACCESSORI / ACCESSORIES

**ACC.0162.0**

ganci per fissaggio cavi (sacchetto 10 pezzi)

hooks for cable fixing (10 pieces bag)

**ECG.0030.0**modulo dimmer 24 Vdc completo di cavi  
dimmer module 24 Vdc with cables**ACC.0003.0**kit di allineamento  
alignment kit**ACC.0159.0**cavo bipolare 2x0,75 mm<sup>2</sup> - bobina 50 m  
Bipolar cable 2x0,75 mm<sup>2</sup> - 50 m (164 ft) reel**ACC.0156.0** acciaio inox / stainless steel**ACC.0183.0** bianco opaco / matt white**ACC.0282.0** rovere rosso / red oak**ACC.0284.0** rovere chiaro / light oak

Coppia di tappi terminali per versione a incasso

Couple of end caps for recessed version

**ACC.0157.0** acciaio inox / stainless steel**ACC.0184.0** bianco opaco / matt white**ACC.0283.0** rovere rosso / red oak**ACC.0285.0** rovere chiaro / light oak

Coppia di tappi terminali per versione da superficie

Couple of end caps for surface mounted version

Montaggio a incasso per cartongesso o muratura  
Recessed mounting for plasterboard or concreteMontaggio da superficie  
Surface mounting